

Valve Pv90: Manually operated or electrically operated valve with PD9

Spare parts (Page 1/2)

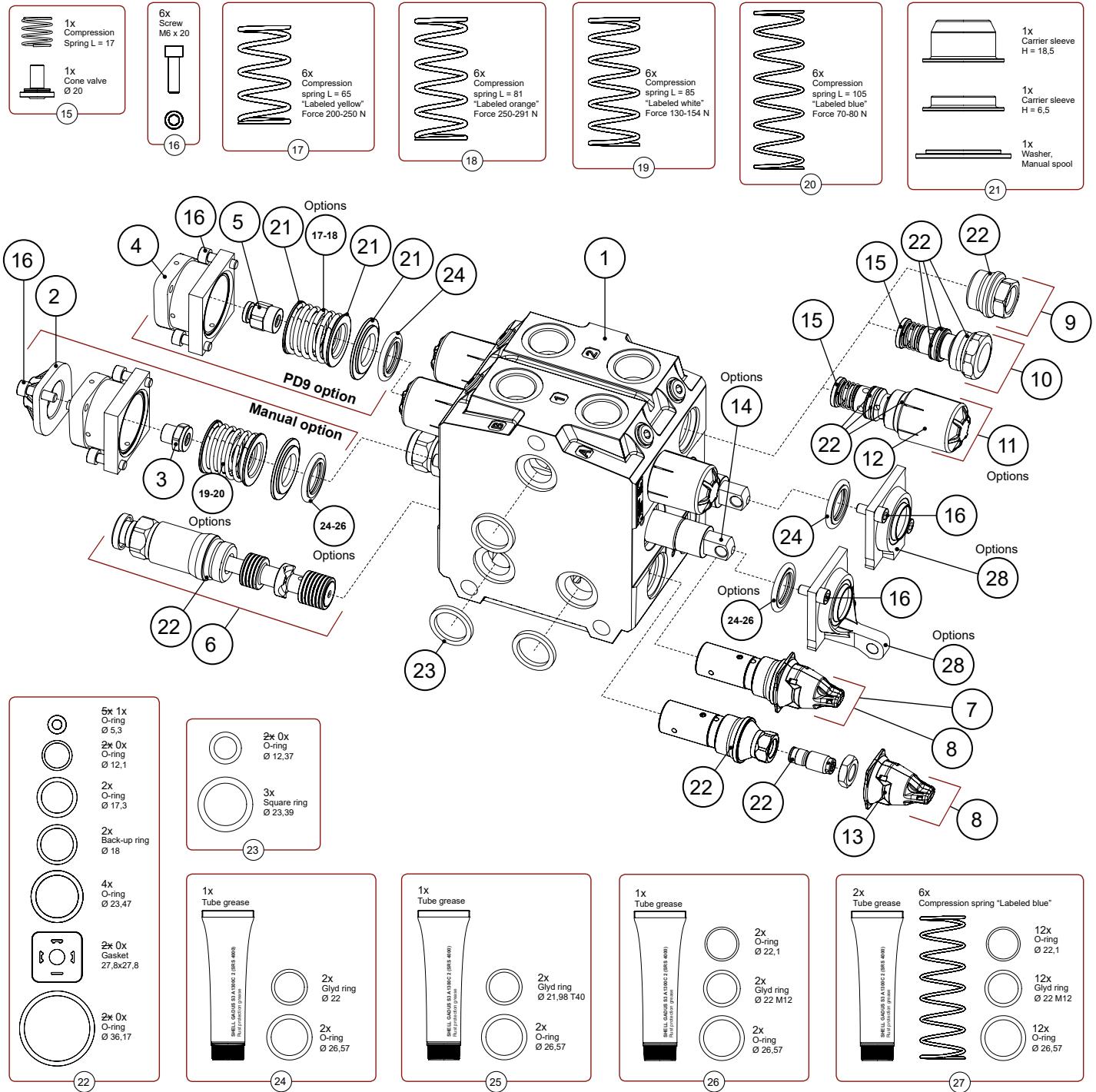

Pos.	Part no.	Description	Note
1	xxxx	Valve Pv90 Man. / Valve Pv90 EI-PD9	
2	V2121	Cover plate V	
3	V2120	Bolt, manual	
4	P0181	Cover V, complete	Incl. o-rings
5	P0191	Bolt, CombiDrive	
6	V0760	Pressure compensator Pv90	
7	V0751	Signal relief valve complete without shuttle valve	For last section, see valve specification
8	V0750	Signal relief valve complete with shuttle valve	For last section, see valve specification
9	V0741	Plug TK G 3/4", complete	Incl. o-ring
10	V0740	Chock valve P plug Pv90	
11	V1xxx	Shock valve xx MPa standard	See page 37
12	V2271GR	Plastic cap grey, shock valve	
13	V2589GR	Closure sealing, grey	Consumption: 1 pcs per signal relief valve
14	V32xxx	Spool xxx-man xx-xx-xx	See valve specification and page 38 - 46

Valve Pv90: Manually operated or electrically operated valve with PD9

Spare parts (Page 2/2)

** = some parts of the kit is not needed

Pos.	Part no.	Description	Note
15	V9045	Anti-cavitation kit Pv90	Consumption: 1 kit per shock valve
16	V9007	Screw package Man	Consumption: 1 kit per valve section
17	V9047	Spring set x6 yellow	Consumption: 1 kit per 6 valve sections
18	V9023	Spring set x6 orange	Consumption: 1 kit per 6 valve sections
19	V9005	Spring set x6 white	Consumption: 1 kit per 6 valve sections
20	V9046	Spring set x6 blue	Consumption: 1 kit per 6 valve sections
21	V9008	Spring guide package spool	Consumption: 1 kit per valve section
22	V9004	Sealing package TV2	Consumption: 1 kit per valve section**
23	V0762	Seal kit	Consumption: 2 kit per valve**
24	S1102	Sealing kit spool	Consumption: 1 kit per valve section
25	V2541	Sealing kit spool	Consumption: 1 kit per valve section
26	V2468	Sealing kit spool	Consumption: 1 kit per valve section
27	V2520	Low friction kit	Consumption: 1 kit per 6 valve sections
28	-	Console	See page 31