

# Hiab Grapples for handling timber and recycling materials





## A Grapple for Every Need

The Hiab range of grapples features several alternatives for handling timber and recycling materials.

The timber grapples are designed for demanding work. They penetrate log piles, straighten logs and load them effortlessly. A practical design provides the light-weight grapples with durability and power, while the single-cylinder design with few moving parts guarantees a long and carefree service life. With the

yellow Hiab timber grapples you can load quickly and reliably year after year.

### **Hiab Lasts**

These grapples are designed for hard wear and tear, taking the special requirements of handling demolition waste and scrap into consideration.

Due to their durable materials and design, the red Hiab grapples are the best choice for handling recycling materials of any kind.

Hiab grapples can be equipped with a lock valve. A centralised lubrication system is also available for most models.



## X43 X53

The X series grapples, X43 and X53 are eminently suitable for mid-sized truck loaders for loading pulpwood and logs.

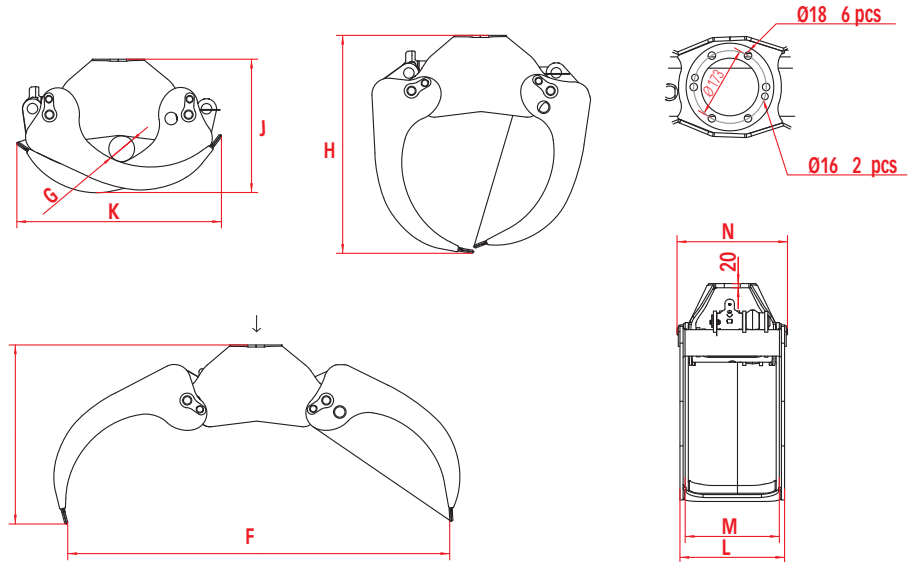

## FX26 FX36 FX42

The FX series is designed to withstand the demanding use of forestry machines. The FX26 and FX36 are suited for forestry cranes and lightweight truck loaders. The FX42 is suited for heavy forestry machine and skidder cranes.

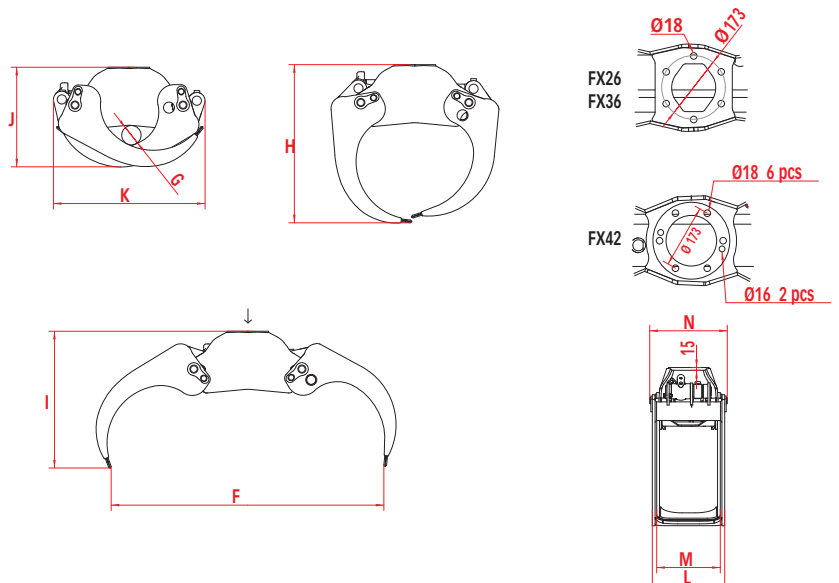



## TX56 TX56B

The heavy TX series grapples are used in industrial cranes in addition to truck loaders. The TX56 is optimised for loading raw timber using heavy truck loaders, while the reinforced TX56B is also suitable for use on excavators.

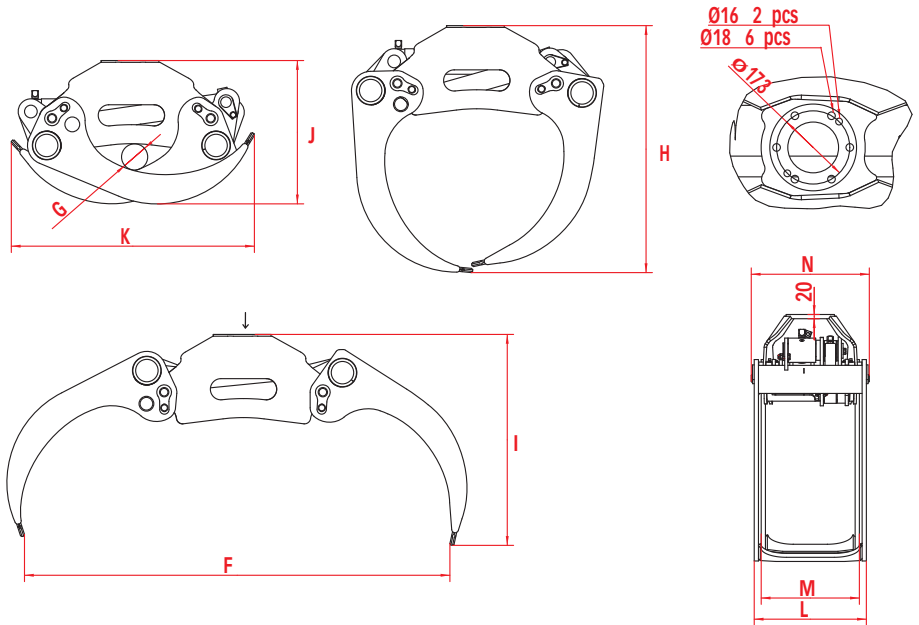

## TX86B TX811B

The heavy TX86B and the TX811B, with its wider jaws, can be installed on industrial cranes and excavators.

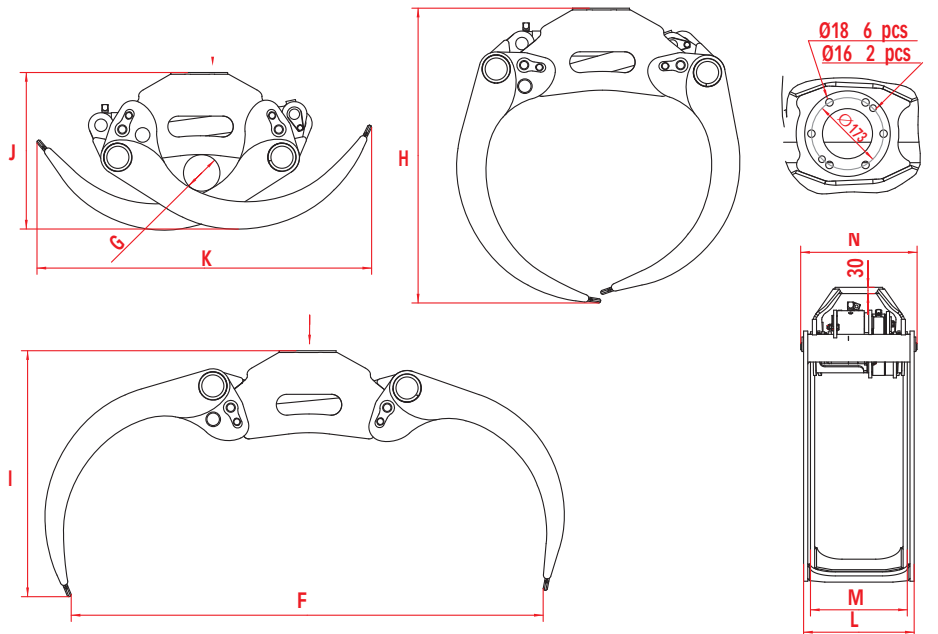



## RX31 RX51

The RX series grapples are designed for handling logging waste and refuse. The RX31 grapple is used in forestry machine loaders, and the RX50 is suitable for larger loaders.

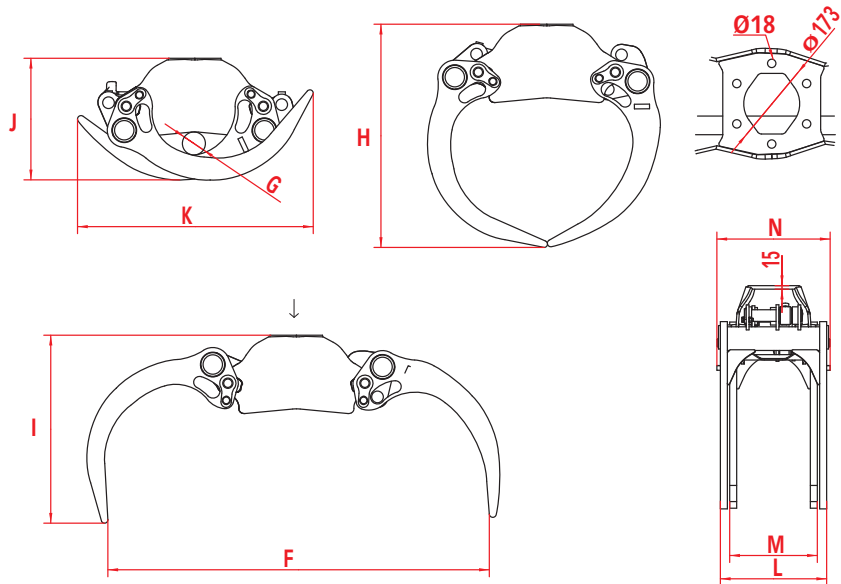

## PX20 PX40

The PX series grapples are well suited to handling individual logs. The PX20 is intended for industrial cranes used in timber processing lines. The PX40 is designed for use in light skidder cranes.

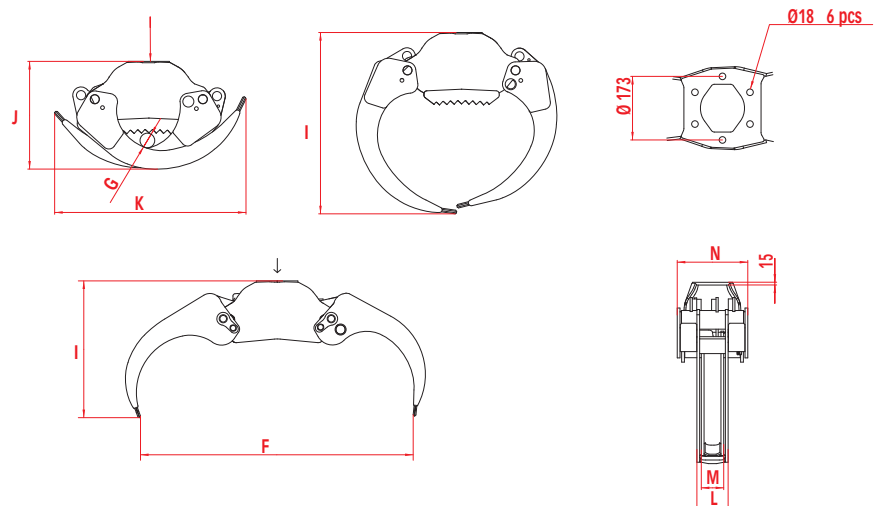



## For Hard Wear and Tear

Hiab features the RC range for handling recycling materials, having been specifically designed for this in co-operation with professionals. Because handling demolition waste and

scrap causes much wear and tear, the steel used in these grapples is much more wear-resistant than normal. The grapples' open tips act as effective rakes when collecting scrap.



RC30  
RC50  
RC50-67

The RC series grapples are designed for handling recycling material and demolition waste, the RC30 for medium cranes, and the RC50 and RC50-67 (with its denser teeth) are suitable for larger cranes.

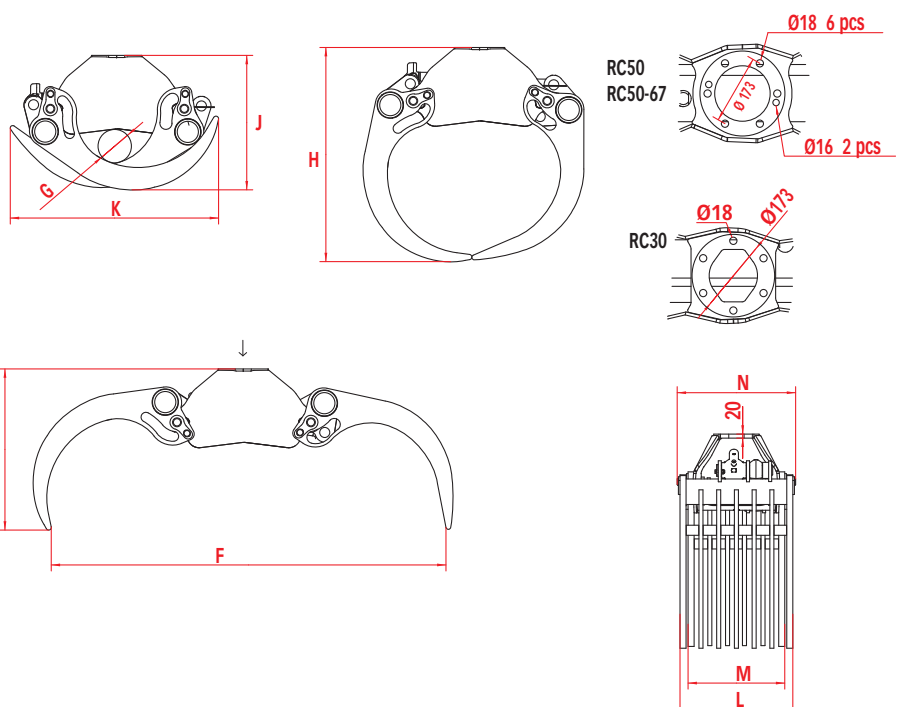

# Hiab Grapples technical data

Model	Holding area m <sup>2</sup>	Max. load kg	Max. working pressure MPa	Jaw pressure (jaw against jaw) kN/MPa	Weight kg	F. Max grip width mm	G. Min. diameter Ø mm	H. Height, jaw against jaw mm	I. Height, opened mm	J. Height, closed mm	K. Width, closed mm	L. Width, outer jaw mm	M. Width, inner jaw mm	N. Max. width mm
PX20	0.2	3000	20	12/20	135	1100	40	915	880	590	840	145	40	245
PX40	0.4	4000	25	11.9/25	185	1600	80	985	840	585	1045	170	122	412
RX31	0.35	4000	25	14.1/25	200	1640	100	960	805	520	1010	456	376	486
RX51	0.5	5000	23	17/23	265	1960	165	1055	800	660	1035	560	480	590
FX26	0.25	4000	25	14.1/25	165	1485	105	860	745	540	825	394	346	422
FX36	0.35	4000	25	13.1/25	175	1570	105	925	785	570	935	394	346	422
FX42	0.4	6000	24	19/24	250	1825	120	1040	855	635	975	520	460	548
X43	0.4	5000	23	18/23	220	1825	120	1040	855	635	980	500	450	528
X53	0.5	5000	23	17/23	225	1985	165	1075	810	670	1040	500	450	528
TX56	0.5	9000	27	21.7/27	340	2010	120	1165	995	675	1150	530	464	558
TX56B	0.5	9000*	27	21.7/27	345	1975	120	1165	1015	675	1150	530	464	558
TX86B	0.8	9000*	27	19.1/27	360	2260	175	1415	1180	750	1605	530	464	558
TX811B	0.8	9000*	27	19.1/27	455	2260	175	1415	1145	750	1605	1000	930	1000
RC30	0.35	4000	25	12.5/25	235	1640	130	960	805	565	1000	456	376	484
RC50	0.5	5000	23	17/23	350	1960	165	1065	800	665	1035	560	480	588
RC50-67	0.5	5000	23	17/23	405	1960	165	1065	800	665	1035	560	480	588

\* Max. load down 2000 kg

We reserve the right to make changes. Illustrations, drawings and data are not always in accordance with the latest version or standard model in production. The models in the pictures may present special equipment or colours.

*Cargotec improves the efficiency of cargo flows on land and at sea - wherever cargo is on the move. Cargotec's daughter brands, Hiab, Kalmar and MacGregor are recognised leaders in cargo and load handling solutions around the world. Cargotec's global network is positioned close to customers and offers extensive services that ensure the continuous, reliable and sustainable performance of equipment. [www.cargotec.com](http://www.cargotec.com)*



[www.cargotec.com](http://www.cargotec.com)  
[www.hiab.com](http://www.hiab.com)