

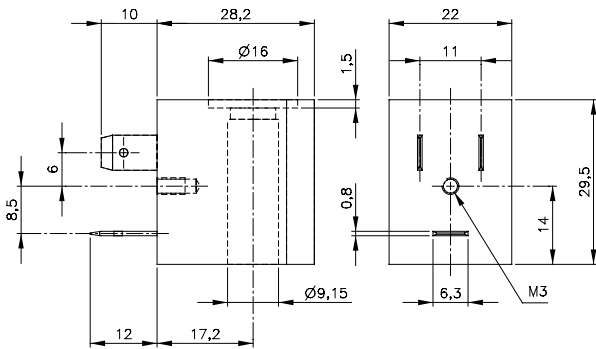

22 mm wide coils for solenoid valves of the MH-series, type MH, MOH, MEH, MEOH, MNH and MNOH.

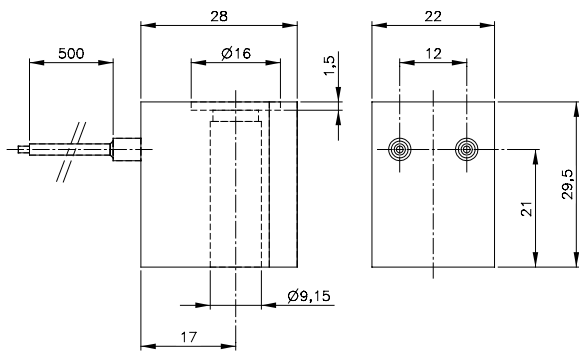

MA 22/MA 22 D/MA 22 U



MA 22 L

Type MA 22

Housing made from heat resistant thermoplastic polyester material 30 % glass filled.
Interface industry form B (DIN / ISO 436 50).
Isolation class F. Wire class H.
Equipped with appropriate connector, solenoid offers IP 65.

Type MA 22 U

Same as MA 22 but with UL-certification. 
AC-coils can be operated at 50 Hz and 60 Hz.

Type MA 22 L

Housing made from heat resistant thermoplastic polyester material with 30 % glass filled.
Isolation class F. Wire class H.
Version with flying leads. Cable length 500 mm, others available on request. The coils are not grounded, take national safety regulations into consideration!

Type MA 22 D

Housing made from Epoxy.
Interface industry form B (DIN/ISO 436 50).
Isolation class F. Wire class H
Equipped with connector type ST 22 L 5000 or ST 222 V __ L 1500 and additional O-rings the system offers IP 67.

Suitable connectors for coils displayed on this page, type ST 22 ..., can be found on page 2.13.3.

| Type | Voltage | Tolerance | Ampere | Power cons. | Connection |
|------------------|---------|-----------|--------|-------------|--------------------------|
| MA 22 12DC | 12 V= | ±10 % | 250 mA | 3 W | Industry form B |
| MA 22 24DC | 24 V= | ±10 % | 125 mA | 3 W | Industry form B |
| MA 22 L700 24DC | 24 V= | ±10 % | 125 mA | 3 W | Flying leads 700 mm long |
| MA 22 48DC | 48 V= | ±10 % | 62 mA | 3 W | Industry form B |
| MA 22 220DC | 220 V= | ±10 % | 14 mA | 3 W | Industry form B |
| MA 22 24AC | 24 V~ | ±10 % | 200 mA | 5 VA | Industry form B |
| MA 22 110AC | 110 V~ | ±10 % | 45 mA | 5 VA | Industry form B |
| MA 22 L500 110AC | 110 V~ | ±10 % | 45 mA | 5 VA | Flying leads 500 mm long |
| MA 22 230AC | 230 V~ | ±10 % | 22 mA | 5 VA | Industry form B |
| MA 22 L500 230AC | 230 V~ | ±10 % | 22 mA | 5 VA | Flying leads 500 mm long |
| MA 22 D 24DC | 24 V= | ±10 % | 125 mA | 3 W | Industry form B |
| MA 22 D 24AC | 24 V= | ±10 % | 200 mA | 5 VA | Industry form B |
| MA 22 D 230AC | 230 V~ | ±10 % | 22 mA | 5 VA | Industry form B |
| MA 22 U 24DC | 24 V= | ±10 % | 125 mA | 3 W | Industry form B |
| MA 22 U 24AC | 24 V= | ±10 % | 200 mA | 5 VA | Industry form B |
| MA 22 U 110AC | 110 V~ | ±10 % | 45 mA | 5 VA | Industry form B |
| MA 22 U 230AC | 230 V~ | ±10 % | 22 mA | 5 VA | Industry form B |