



From Ton. 12,0

SCRAP  
ROTTAME



## Magnetoil

GUSELLA GM is an electro-magnet with no need of an external generator.  
The GM operates hydraulically and can be mounted very fast on any kind of excavator.

Il GUSELLA GM è un piatto magnetico che non necessita di un generatore esterno.  
Il funzionamento è idraulico e può essere montato con estrema rapidità su qualsiasi escavatore.

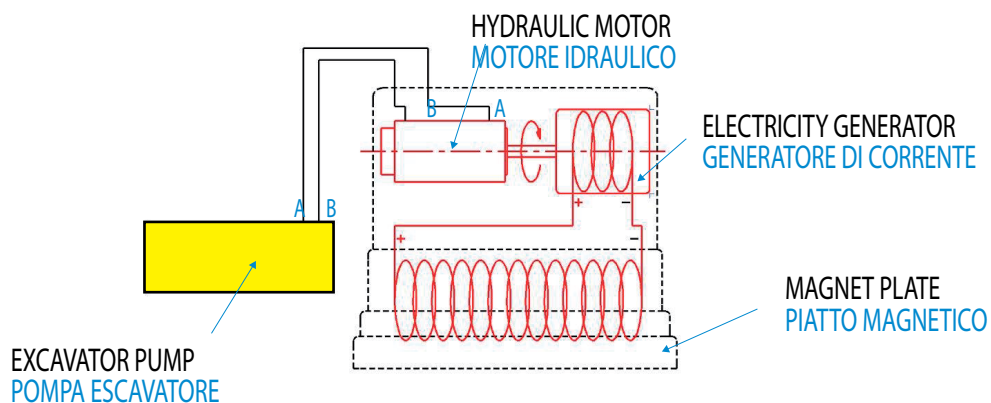

# Magnetoil

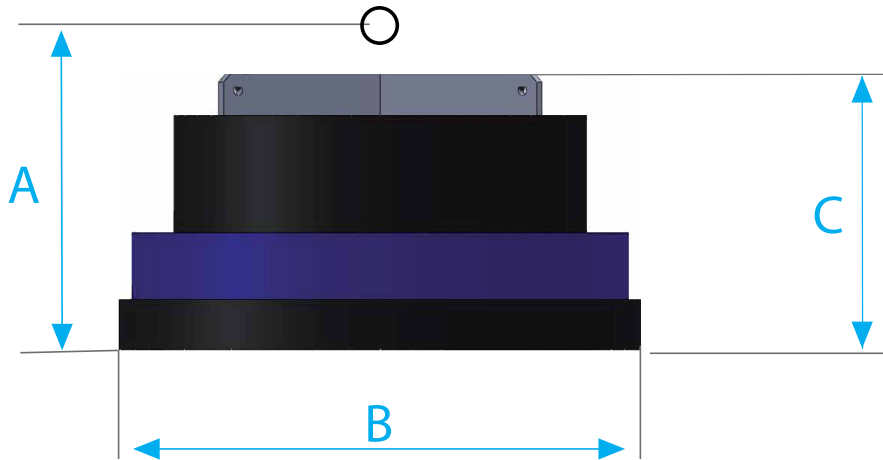

## Type of link Tipo di attacchi disponibili

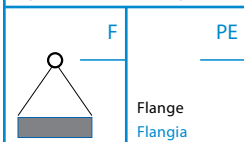

Model Modello	Type of link Tipo attacco	Power Potenza	Pressure Pressione	Weight Peso	Oil capacity Portata olio		Excavator weight Peso escavatore 	Dimensions Dimensioni		
		KW	Bar	Kg.	Lt./min min.	max.		Ton.	A	B
GM 80 L	F	2	60	530	18	50	From 10	780	820	450
GM 80 E	F	3,2	80	650	30	100	From 10	750	820	450
GM 80 ETH	PE	3,2	80	850	30	100	From 14	-	820	450
GM 90 L	F	3.4	100	700	30	100	From 14	900	900	600
GM 100 L	F	5	130	1100	30	100	From 16	1000	1050	620
GM 100 E	F	5,5	110	1150	70	200	From 16	1000	1050	620
GM 110 L	F	6	150	1150	30	100	From 16	1000	1130	620
GM 110 E	F	6,5	120	1200	70	200	From 16	1000	1130	620
GM 110 ETH	PE	6,5	120	1800	70	200	From 16	-	1130	620
GM 120 L	F	7	150	1650	30	100	From 22	1000	1200	620
GM 125 E	F	7,2	150	1650	70	200	From 22	1100	1250	650
GM 125 ETH	PE	7,2	150	2130	70	200	From 22	-	1250	650
GM 126	F	9	150	1810	70	200	From 22	920	1260	670
GM 126	PE	9	150	2250	70	200	From 22	-	1260	670
GM 150	F	11	200	2460	70	200	From 30	1450	1500	750
GM 150	PE	11	200	3150	70	200	From 30	-	1500	750



This data are indicative. To choose the correct attachment check also excavator lifting capacities.  
Il peso dell'escavatore è indicativo, per abbinare la giusta attrezzatura, è necessario consultare il diagramma delle portate dell'escavatore.



10022 Carmagnola (To) Italy  
Via Racconigi, 140  
Tel. +39 011 9692684

6662 NG Elst (Gld) Netherlands  
Nijverheidsweg 6  
Tel. +31 (0)481-374757

info@gusella-bakker.com