

Model:055
Chapter 2 Crane base

1835041
Slewing group assembly (s/n 055 0932 and up)

1835041 - Slewing group assembly (s/n 055 0932 and up)

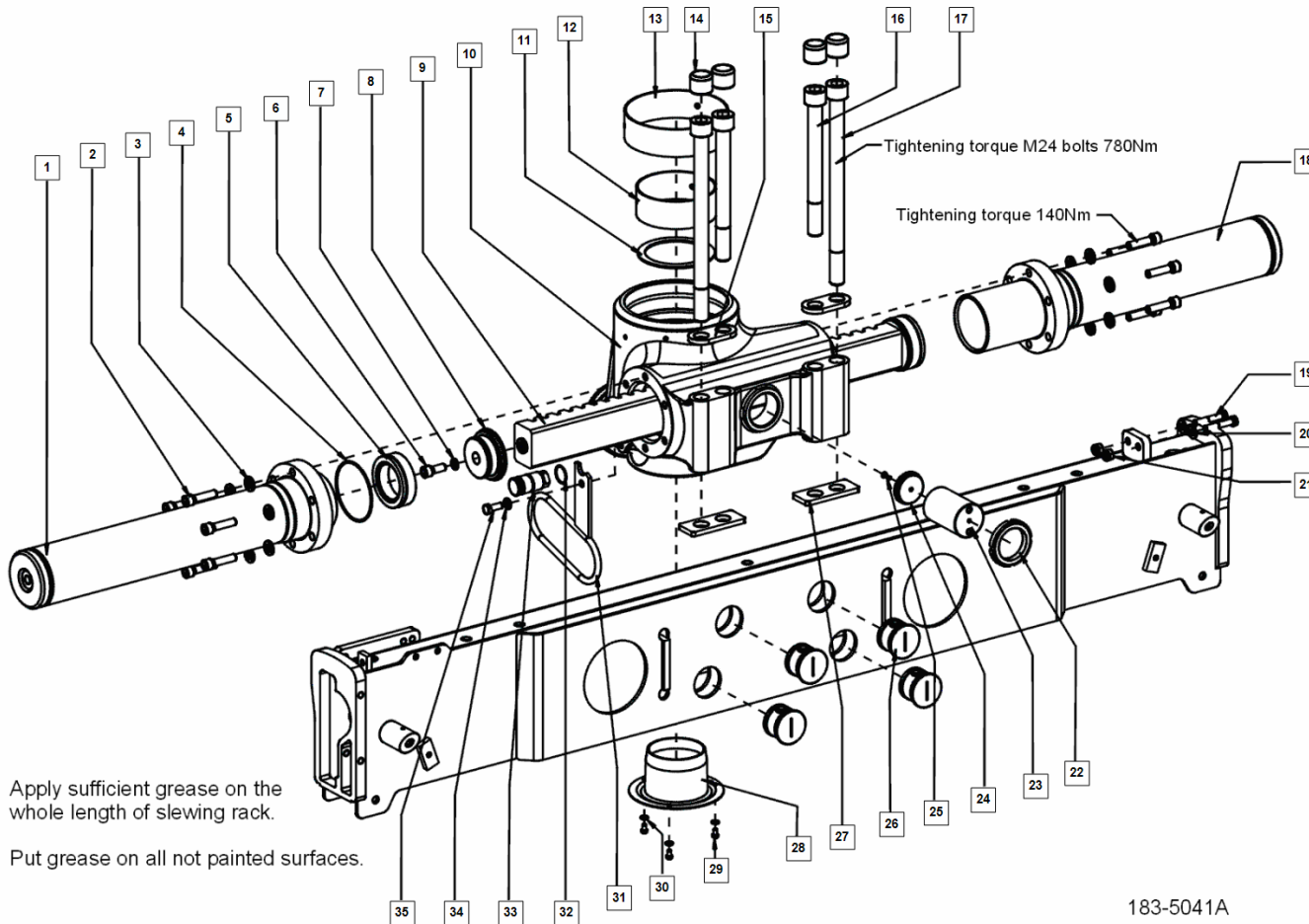

| Pos | Part No | Description | Quantity |
|-----|---------|----------------------------|----------|
| 1 | 1834983 | SLEWING CYLINDER | 1 |
| 2 | 9922695 | SCREW | 12 |
| 3 | 9836187 | WASHER | 12 |
| 4 | 9933476 | O-RING | 2 |
| 5 | 7116672 | SEAL RING | 2 |
| 6 | 9922652 | SCREW | 2 |
| 7 | 9938397 | GS-WASHER | 2 |
| 8 | 1609637 | PISTON SLEWING | 2 |
| 9 | 1604104 | SLEWING TRACK | 1 |
| 10 | 1834967 | SLEWING HOUSE MACHINED | 1 |
| 11 | 1604155 | BEARING | 1 |
| 12 | 549282 | BUSHING 130 135 50 WICO-63 | 1 |
| 13 | 549274 | BUSHING 170 175 50 WICO-63 | 1 |
| 14 | 1845896 | PROTECTION COVER | 4 |
| 15 | 1838709 | PLATE | 2 |
| 16 | 9872736 | SCREW | 2 |
| 17 | 9872744 | SCREW | 2 |
| 18 | 1835025 | SLEWING CYLINDER | 1 |
| 19 | 9900519 | HEXAGON HEAD BOLT | 2 |
| 20 | 9914111 | WASHER | 2 |
| 21 | 9964347 | LOCKING NUT | 2 |
| 22 | 9993509 | NUT | 1 |
| 23 | 1604112 | SCREW FOR RACK | 1 |
| 24 | 1604121 | SLIDEPAD FOR RACK | 1 |
| 25 | 159670 | POP RIVET | 1 |
| 26 | 1835076 | NUT | 4 |
| 27 | 1838717 | PLATE, LOADERBODY HOUSING | 2 |
| 28 | 1604147 | HOSE PROTECTION | 1 |
| 29 | 9976647 | SCREW | 3 |
| 30 | 9903844 | WASHER | 3 |
| 31 | 1835050 | BRACKET | 1 |
| 32 | 9921338 | O-RING | 1 |
| 33 | 1806084 | SECURING PIN | 1 |
| 34 | 9904140 | SPRING WASHER | 1 |
| 35 | 9900471 | HEXAGON HEAD SCREW | 1 |