





CFC	
Orifice (21) in LS port	Plug (35) in Spool
	

LS1	
Plug (35) in LS port	Spool empty
	

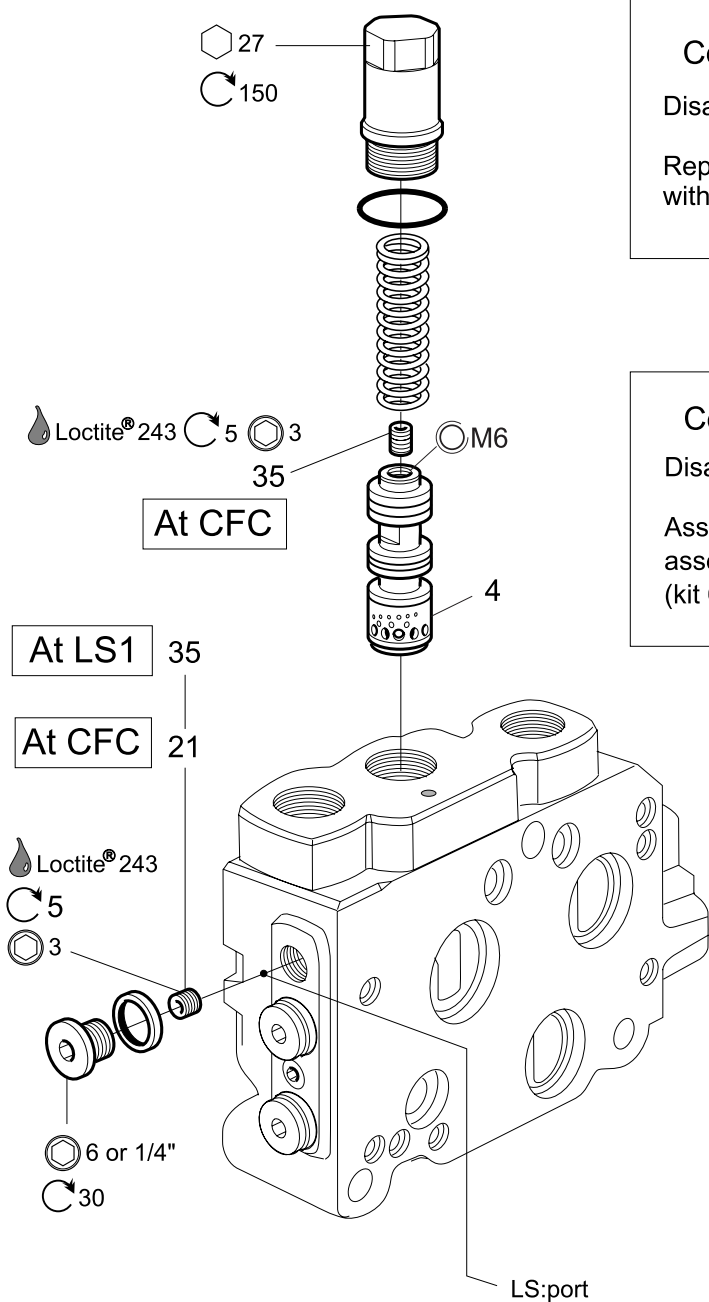

Conversion CFC to LS1:

Disassemble plug 35 from spool 4.

Replace orifice 21 in LS port
with plug 35.

Conversion LS1 to CFC:

Disassemble plug 35 from LS port.

Assemble plug 35 into spool 4 and
assemble orifice 21 to LS port
(kit 6760101*).

*Kit consists of 5 pcs.

 = Tightening torque in Nm

 = Socket head (mm)

 = Hexagon (mm)

 = Locking/sealing fluid