

Mounting instructions

Part No.
500 SERIES

PTO ZF
8AP (Powerline)

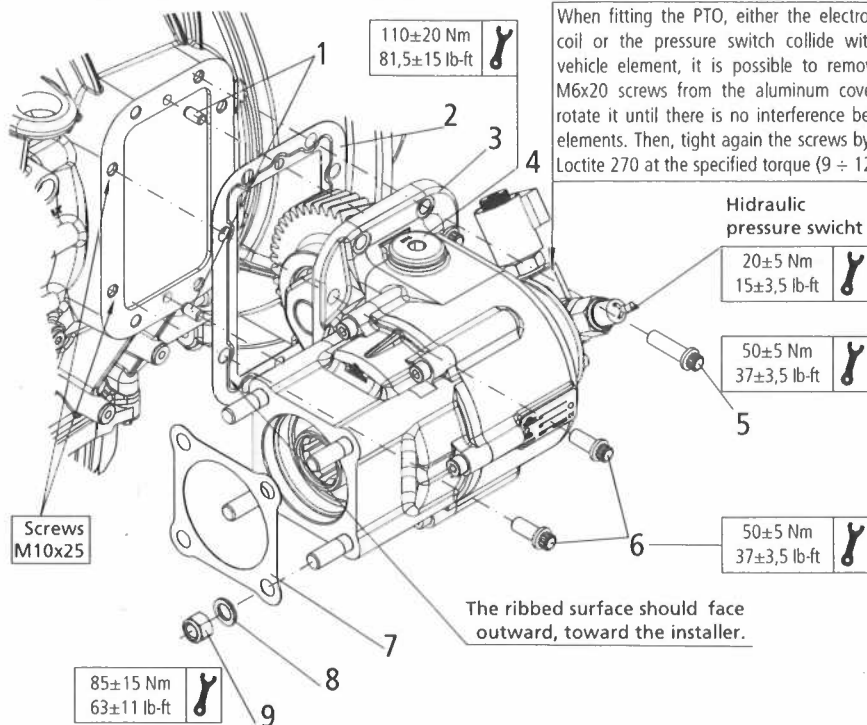

GENERAL INFORMATION

The following installation instruction for fitting the PTO 500 series should be followed in order to ensure good performance and long life.

Where it is obvious that this instructions have not been followed, then warranty claims will not be accepted.

INSTALLATION METHOD

Drain the gearbox and clean the cover plate and surrounding area to prevent ingress of dirt. Remove the PTO cover and clean the sealing surface. Fit the dowels (1) included in the mounting kit.

Fit steel gasket (2) on the gearbox and mount the PTO housing (3). Mount four of the screws (5) in each corner of the PTO mounting flange and fit it to the gearbox applying pressure on its.

Remove both inspection plugs from the PTO. Set a dial indicator through the lower port while manipulate input gear back and forth through the opposite port.

The backlash shall be 0.15-0.3 mm (0.006-0.012").

Fit the PTO with the screws (5 & 6) tighter in accordance with the torque shown in the drawing. Check the final backlash before both inspection plug is being fitted, tight the plugs by using Loctite 270 and at the specified torque in the drawing.

Fit a gasket (7) between pump and PTO housing (3), apply pressure on nuts (9) and its washers (8) in accordance with the torque shown.

See mounting instruction of lubrication and activation pipe shifting kit.

MOUNTING INSTRUCTION LIST

Items	Description
1	Dowel pin (2x)
2	Steel Gasket
3	PTO housing
4	Inspection plug (2x)
5	Screw M10x35 (6x)
6	Screw M10x25 (2x)
7	Gasket
8	Washer (4x)
9	Nut (4x)

**Do not forget to refill the gearbox with suitable oil and up to level.
Drive the vehicle for a short distance, park the vehicle and shut down, then verify.**

Mounting instructions

Part No.
9092299, 9092399

PTO ZF
8AP (Powerline)

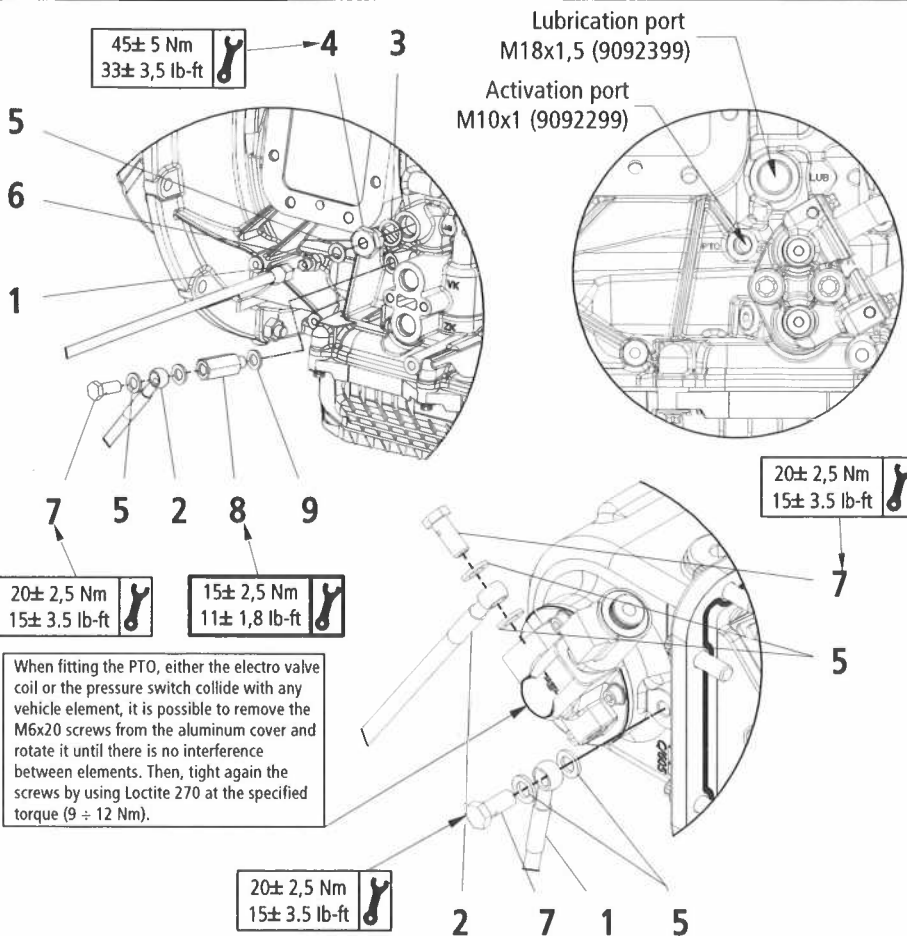

MOUNTING INSTRUCTION LIST

Items	Description
1	Lubrication pipe
2	Activation pipe
3	Copper washer
4	Metric fitting
5	Metalplastic washer (7x)
6	Straight Fitting
7	Holey screw (3x)
8	Adapter plug
9	Aluminium washer (1x)

GENERAL INFORMATION

The following installation instruction for fitting the PTO 500 series should be followed in order to ensure good performance and long life.

Where it is obvious that this instructions have not been followed, then warranty claims will not be accepted.

INSTALLATION METHOD

Remove the plastic plug from the Lubrication port of the PTO and fit the holey end of the lubrication pipe (1) with the holey screw (7) and the metalplastic washers (5).

On the transmission side, remove the plug from the "LUB" port and fit the metric fitting (4) with the copper washer (3).

Then, fit the straight fitting (6), the metalplastic washer (5) and the straight end of the lubrication pipe (1).

Remove the plastic plug from the Activation port of the PTO and fit the holey screw (7), the metalplastic washers (5) and the activation pipe (2).

On the transmission side, remove the plug from the "PTO" port and fit the adapter plug (8) with the aluminium washers (9).

Fit the holey screw (7), the metalplastic washers (5) and the activation pipe (2).

**Do not forget to refill the gearbox with suitable oil and up to level.
Drive the vehicle for a short distance, park the vehicle and shut down, then verify.**