

Binotto®
MOUNTING INSTRUCTIONS
TIPPING VALVE

(order code: DVT#U)

MI_DVT#U • Rev. A • 14 APR 2016 • Pag.1
Working temperature -50°C

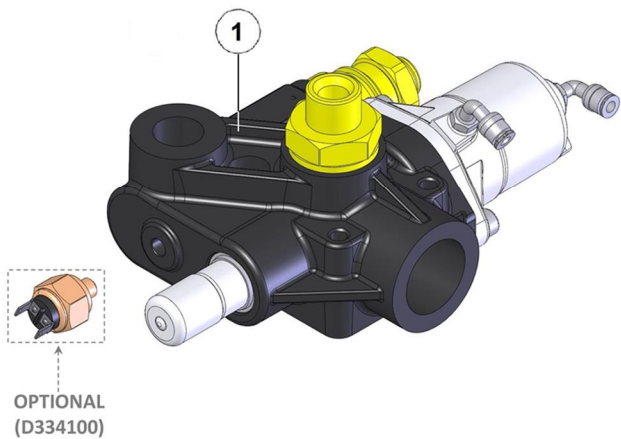

Fig.1

REF	DESCRIPTION ITEM	Q.TY
1	Tipping valve	1

Tab.1

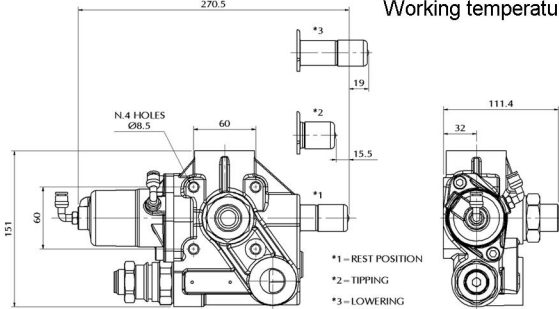

Fig.2

Functioning	Pneumatic	
Body composition	Spheroidal cast iron	
Flow [l/min]	150	
IN port	3/4" BSP	
OUT port	3/4" BSP	
Return tank "T"	1 1/4" BSP	
Weight [Kg]	6,2	
Pressure setting [bar]	190	
Relief valve type	Differential	
Pneumatic connections	Ø6x4mm	

Tab.2

1. FUNCTIONAL DIAGRAM

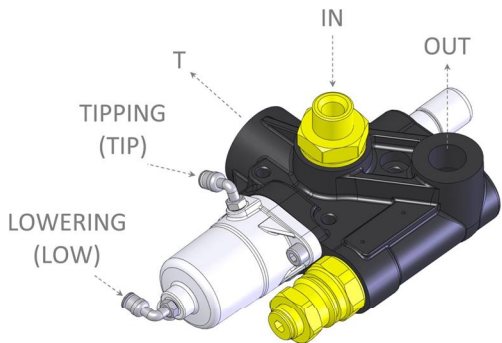

Fig.3

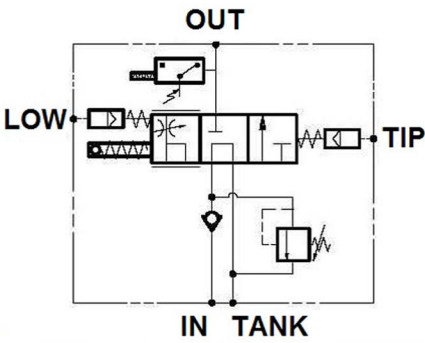

Fig.4

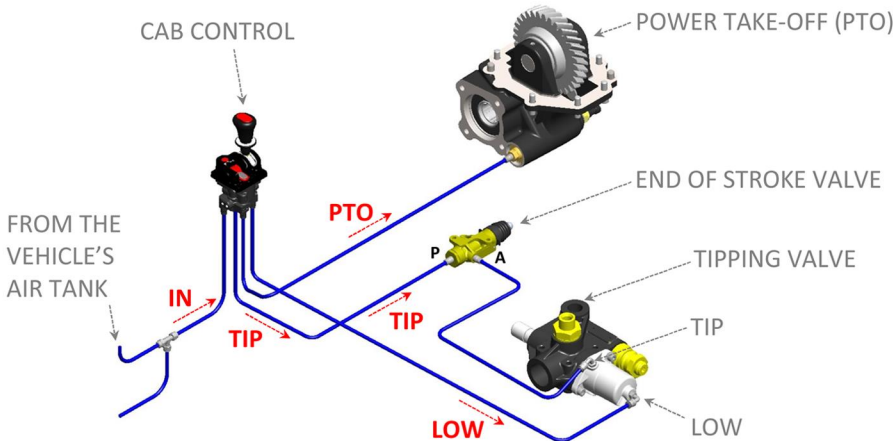

Fig.5

2. RELIEF VALVE SETTING INSTRUCTION



ONLY IF AUTHORIZED BY BINOTTO



- 2.1. Remove the safety seal (blu color);
- 2.2. Unscrew the part. A (see ref.A on Fig.6);
- 2.3. **Screwing** the part. B (see ref.B on Fig.7) the pressure increases.
Unscrewing the part. B (see ref.B on Fig.7) the pressure decreases.
Check the pressure with a pressure gauge;
- 2.4. Lock the part. A (see ref.A on Fig.8) but keeping the carefully position to part. B (see ref.B on Fig.8);

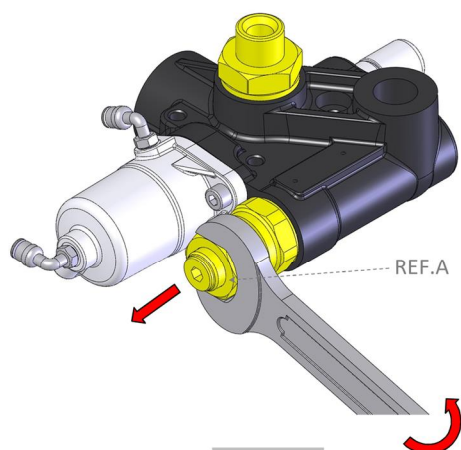

Fig.6

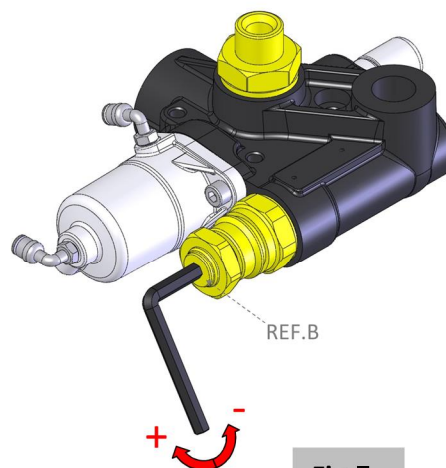

Fig.7

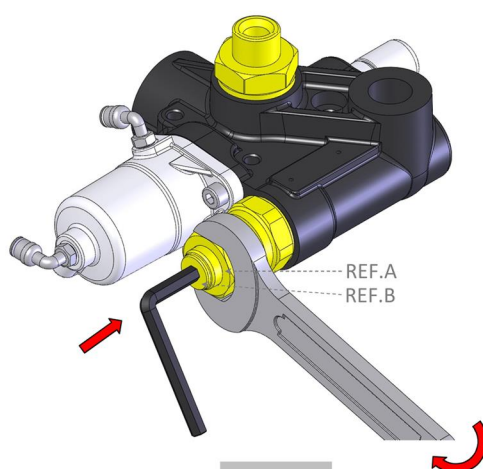

Fig.8

3. INSTRUCTIONS FOR MOUNTING ON OIL TANK

3.1. Take n.4 screws M8x65 (see ref.01 on Fig.9) and, interposing n.4 washers Ø8 (see ref.02 on Fig.9), screw them into its 4 holes (see Fig.10).

WARNING : take care to screw the n.4 screws M8x65 (see ref.01 on Fig.9) with a tightening torque of 30 Nm in order to avoid any oil leakage (see Fig.11). After completely tightening the screws, check with your hands (pushing and pulling) if the piston rod is free to move.

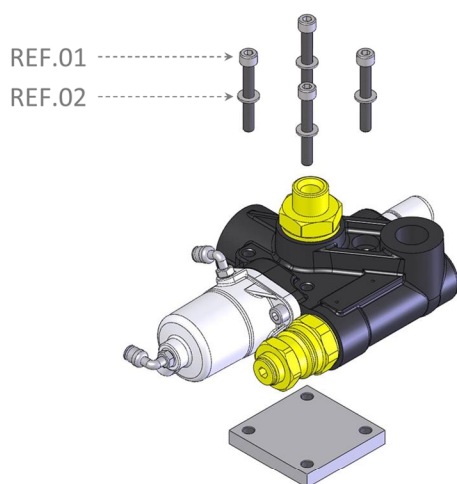

Fig.9

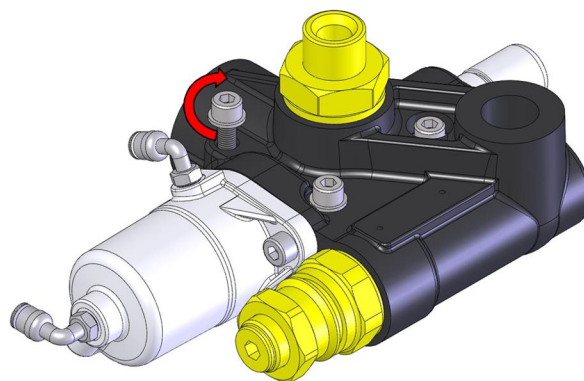

Fig.10

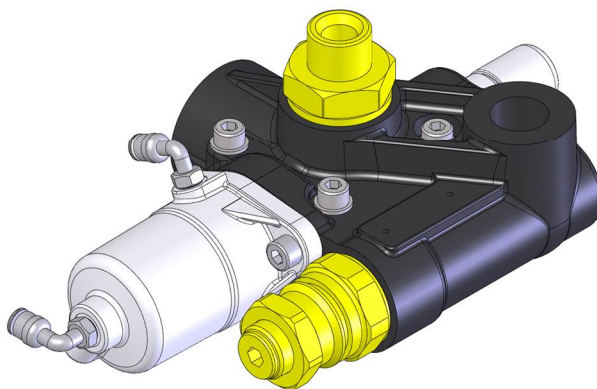

Fig.11