

502.1 608554 Functions Manifold

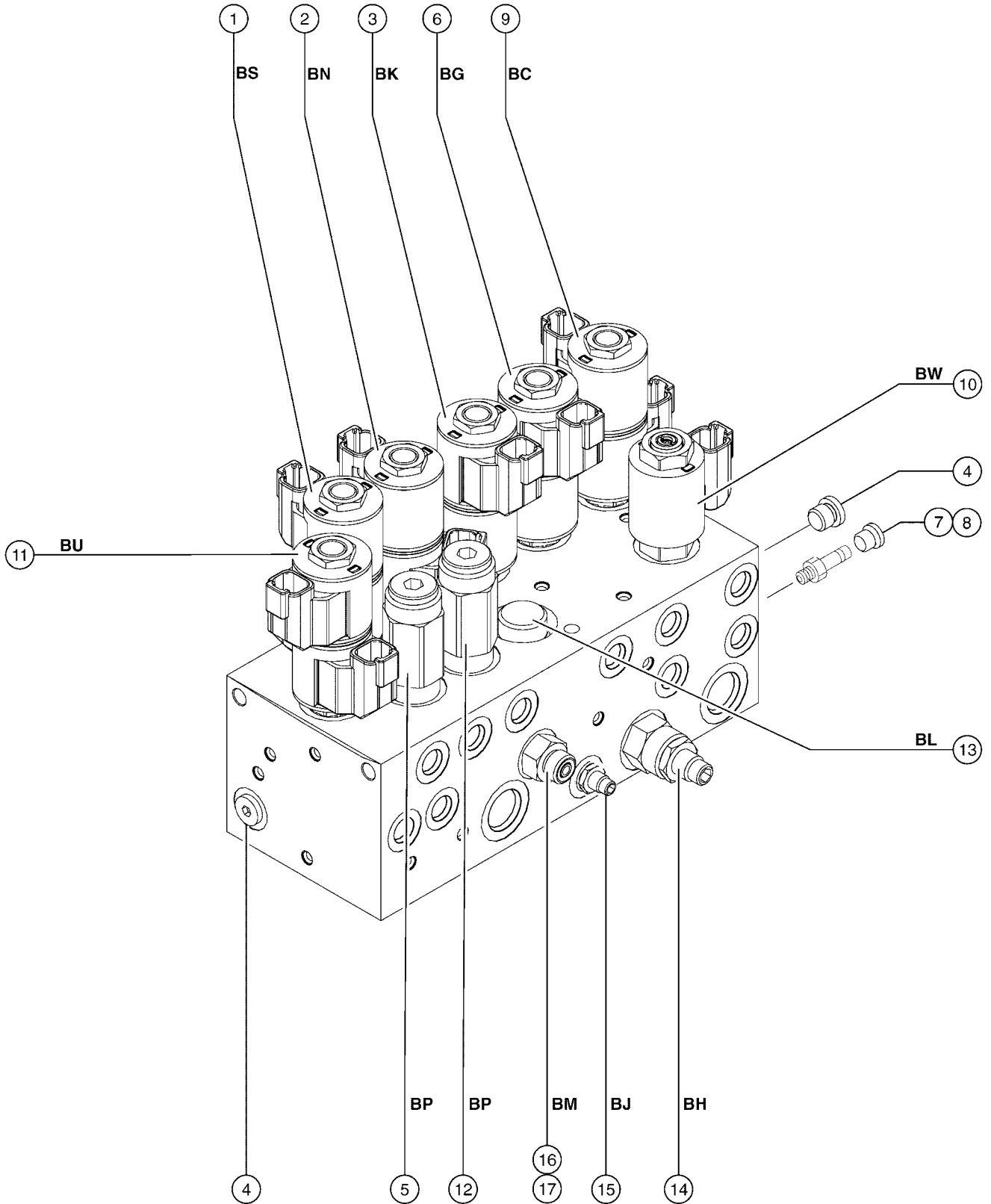

Item	Part No.	Description	Qty.
1	107816GT	VALVE,PROPORTIONAL 3 POS 4 WY* BS, Primary boom up/down	
1-	119827GT	COIL, 20V, ZENER DIODE DEUTSCH	
1-	44229GT	SEAL KIT, VALVE	
2	107816GT	VALVE,PROPORTIONAL 3 POS 4 WY* BN, Secondary boom up/down	
2-	119827GT	COIL, 20V, ZENER DIODE DEUTSCH	
2-	44229GT	SEAL KIT, VALVE	
3	107816GT	VALVE,PROPORTIONAL 3 POS 4 WY* BK, Turntable rotate curcuit	
3-	119827GT	COIL, 20V, ZENER DIODE DEUTSCH	
3-	44229GT	SEAL KIT, VALVE	
4	07.0704.0421GT	SAE PLUG	
5	1259732GT	VALVE RELIEF,130BAR - 1885PSI BP, Primary boom down	
6	39346GT	VALVE,SOLENOID 3 POS.4 WAY*** BG, Platform level up/down	
6-	119827GT	COIL, 20V, ZENER DIODE DEUTSCH	
6-	44229GT	SEAL KIT, VALVE	
7	48997GT	NIPPLE,DIAGNOSTIC,#4	
8	48880GT	CAP,DIAGNOSTIC NIPPLE	
9	119828GT	VALVE,PROPORTIONAL 3 POS 4 WY* BC, Steer left/right	
9-	119827GT	COIL, 20V, ZENER DIODE DEUTSCH	
9-	44229GT	SEAL KIT, VALVE	
10	119830GT	VALVE,PROPORTIONAL RELIEF BW, System relief	
10-	119825GT	COIL, 24V, DEUTSCH NO DIODE	
10-	44227GT	SEAL KIT, VALVE	
11	107788GT	VALVE,PROPORTIONAL 3 POS 4 WY BU, Primary boom extend/retract	
11-	119827GT	COIL, 20V, ZENER DIODE DEUTSCH	
11-	44229GT	SEAL KIT, VALVE	
12	1259732GT	VALVE RELIEF,130BAR - 1885PSI BP, Secondary boom down	
13	07.0704.0424GT	VALVE BL, Turntable rotate curcuit	
14	101055GT	VALVE,NEEDLE,FINE ADJUSTMENT** BH, Platform level up/down	

